

NOTES:

- ① TORQUE BRUSH COVER SCREWS TO 1.2 N-m (11 IN-LBS.).
- ② TORQUE POWER TERMINAL M6 NUTS TO 5.7 N-m (50 IN-LBS.) (AT INSTALLATION).
- 3. SPECIFICATIONS  
RATING: UL 583, 50A CONTINUOUS,  
60VDC (25VAC) MAX  
POSITIONING TOLERANCE +/-: X=5MM;  
Y=16.5MM; Z=2.5MM
- ④ TARGET MOUNTING DISTANCE AT MID-STROKE. BRUSHES SHOWN WITH 0.5MM PRELOAD.
- ⑤ MOUNTING HARDWARE: M5 SOCKET HEAD CAP SCREW.

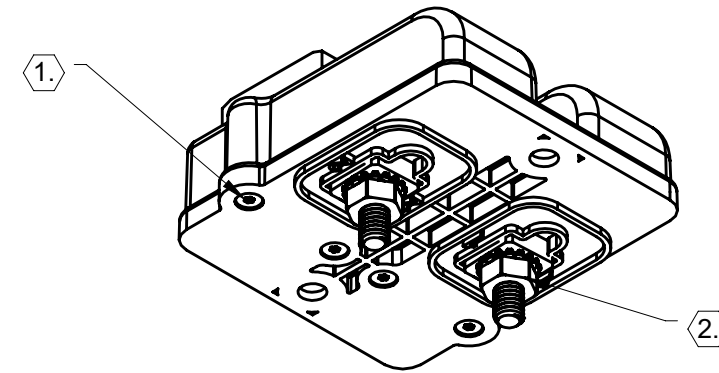
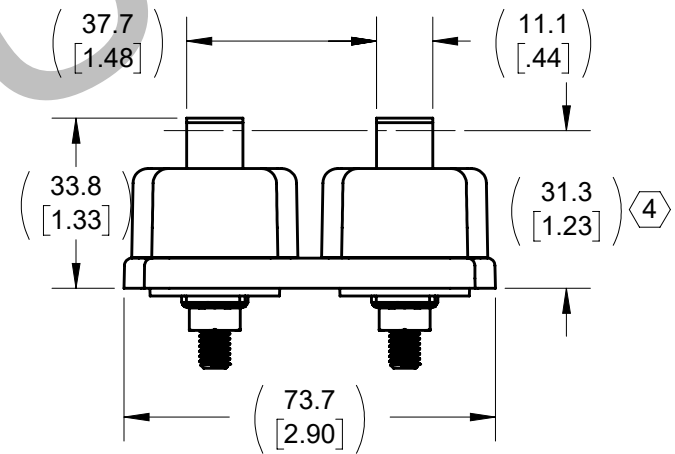
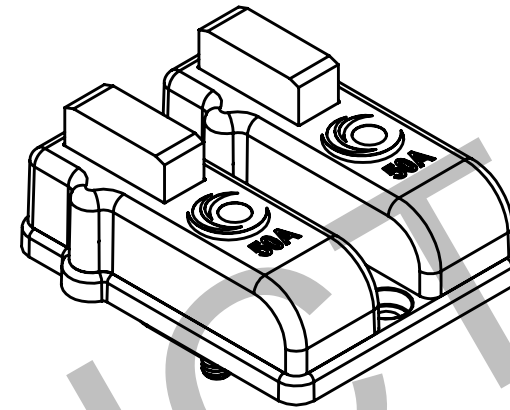
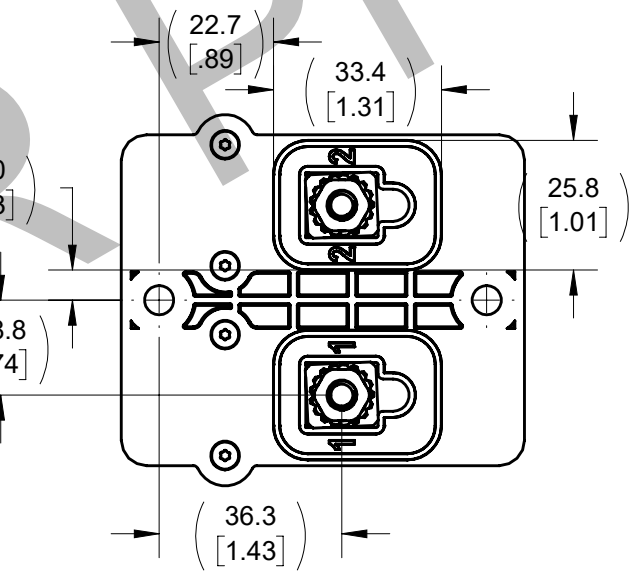
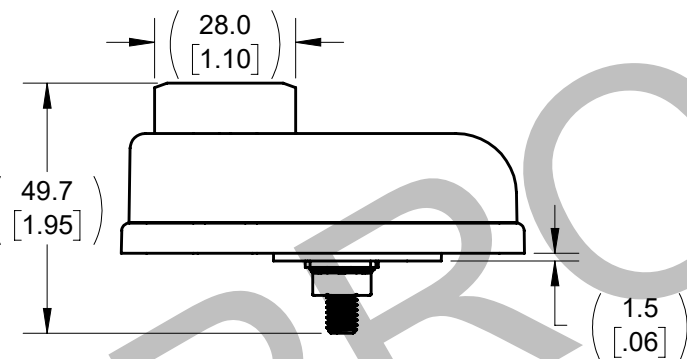
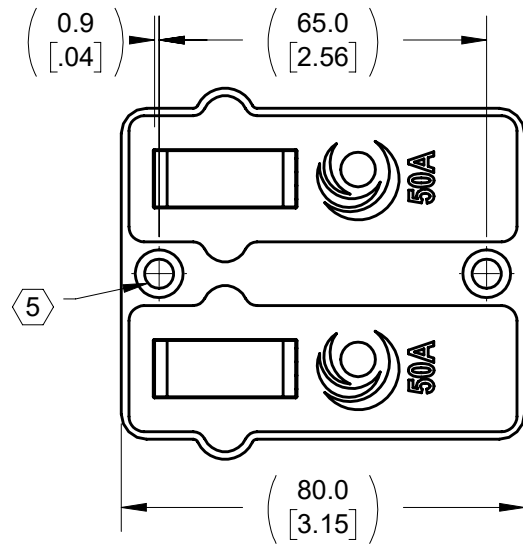
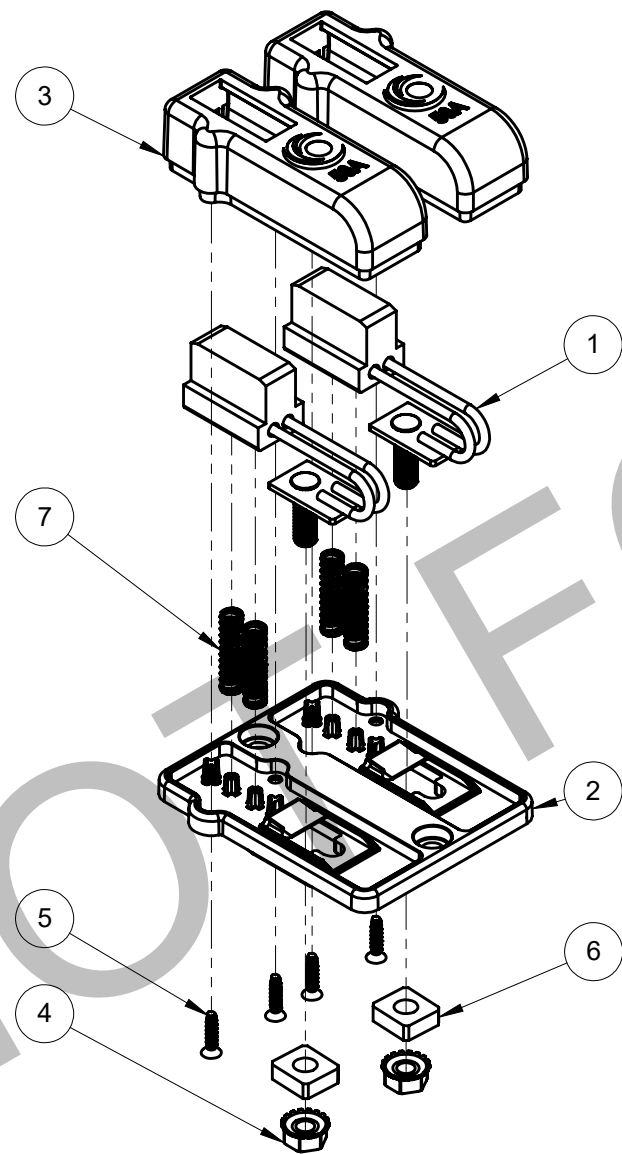

ITEM	MATERIAL NO. 2	DESCRIPTION	QTY.	UNIT
7	XA-598862	SPRING COMPRESSION .24 OD X .17 ID X 1.0	4	PC
6	XA-594129	SPACER TERMINAL MCC LUG	2	PC
5	XA-591656	SCREW 4-20 x .50 LG THD ROLL PLSTC SST	4	PC
4	XA-104380	NUT M6-1.00 HEX KEPS SST	2	PC
3	XA-601762	HOUSING COLLECTOR 50A NANO+	2	PC
2	XA-600052	COVER MOUNT DOUBLE 50A NANO+	1	PC
1	XA-601520	BRUSH ASSEMBLY 50A NANO+	2	PC

STATUS: PRE-RELEASED		DESCRIPTION: COLLECTOR ASSY DOUBLE 50A NANO+	
ER NO. ECO-49916	UNLESS OTHERWISE SPECIFIED	PROPRIETARY AND CONFIDENTIAL	
ER DATE: 10/07/2022	INTERPRET GEOMETRIC TOLERANCING	This drawing and the information shown constitute trade secret and confidential property of Conductix-Wipac, Inc. It is subject to recall, and is loaned for use only in connection with the authorized manufacture or installation of Conductix-Wipac products, and on the condition that it will be treated as confidential and will not be disclosed, published or reproduced in whole or in part, or permitted to be viewed or used by any other party, without specific written permission. Receipt and use of the drawing and information constitutes acceptance and agreement to the above.	
ER ENGR: J SMITH	PER: ASME Y14.5	10102 F Street Omaha, NE 68127 800-521-4888	
ER APPR: D SAMPSON	PRIMARY UNITS ARE IN MM KG SECONDS	MATERIAL NO. 2: XA-CCC050A2W0	
DRAWN: J SMITH	SECONDARY UNITS IN INCH LB SECONDS	REV 0	
09/09/2022	TOLERANCES ARE AS FOLLOWS:	WEIGHT(REF): 0.23 KG	
	DECIMAL =	MATL:	
	X . ±2.5 MM [0.1 IN]	SIZE B SCALE: 2:3	
	X.X ±0.8 MM [0.03 IN]	SHEET 1 of 1	
	X.XX ±0.25 MM [0.010 IN]		
APPR: D SAMPSON	ANG: ±1°		
09/09/2022	THREAD CLASS: 6G EXTERNAL / 6H INTERNAL		
	ALL DIMENSIONS GREATER THAN 60MM HAVE A TOLERANCE OF .2MM UNLESS OTHERWISE SPECIFIED		